

## Traffic Management Plan 2018

Jesuit College Preparatory School of Dallas  
Amendment to Planned Development No. 353  
Dallas, Texas

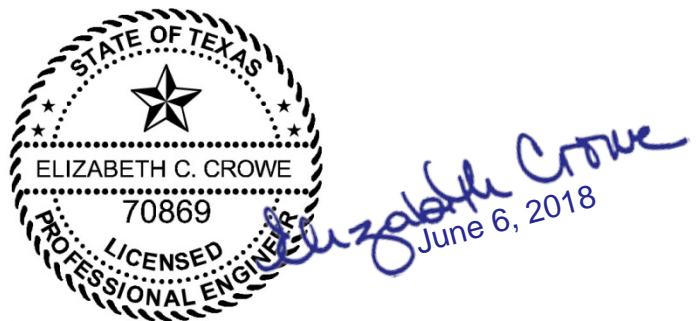

Walter P. Moore and Associates, Inc.  
TBPE Firm Registration No. 1856

Prepared for  
Jesuit College Preparatory School of Dallas

Prepared by  
WALTER P MOORE

Walter P. Moore and Associates, Inc.  
1845 Woodall Rodgers Freeway, Suite 1650  
Dallas, Texas 75201  
Project No. M04-17002.00

June 2018

## INTRODUCTION

Jesuit College Preparatory School of Dallas (Jesuit) operates within a Planned Development 353 (PD) at the campus at 12345 Inwood Road in Dallas, Texas. The all-male student high school had an enrollment of approximately 1,130 students for the 2017-2018 school year. Jesuit is preparing to implement modifications to the campus which require a minor amendment to the PD. Jesuit acquired the services of Walter P Moore (WPM) to review the current operations for student drop-off and pick-up and prepare a Traffic Management Plan (TMP) to better serve the campus with the planned modifications at the campus.

## CURRENT OPERATIONS

Jesuit operates on a common arrival and departure time for all students. The morning start time for classes on most days is 8:00 AM, however, many students, teachers and staff arrive to the campus beginning at 6:30 AM. Multiple sport practices and club/organization meetings are held prior to school classes. On most Tuesdays, the school has Late Arrival at 8:30 AM. The afternoon release time on most days is 3:41 PM and several sport teams as well as other extracurricular activities hold practice or meetings after school. The dismissal time for St. Rita Catholic School, adjacent to Jesuit on the north side, is 3:30 PM.

## SITE ACCESS

**Figure 1** provides the location of the five driveways along Inwood Road that serve all vehicular access for the Jesuit main campus.

The most northern driveway (Driveway 1) provides both inbound and outbound traffic and is primarily utilized by staff and students who park on campus. The median opening on Inwood Road serves inbound traffic only for both Driveway 1 and the driveway immediately to the north for St. Rita Catholic Church and School. Driveway 2 is utilized for inbound traffic only and the median opening on Inwood Road provides a sheltered northbound left turn lane for inbound traffic from the south.

Driveway 3 allows for both inbound and outbound traffic at a median opening with a sheltered northbound left turn lane. Jesuit security staff provides traffic control assistance at Jesuit Driveway 3 and Inwood Road intersection during peak student drop-off and pick-up times. Pedestrian flashing signs and painted crosswalk are provided at this location. Motorists were observed to yield right-of-way to pedestrians crossing.

# WALTER P MOORE

WALTER P. MOORE AND ASSOCIATES, INC.  
 1845 WOODALL RODGERS FREEWAY, SUITE 1650  
 DALLAS, TEXAS 75201.2287

PHONE: 214.740.6200 FAX: 214.740.6300

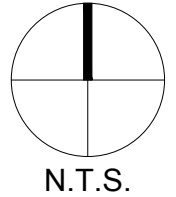
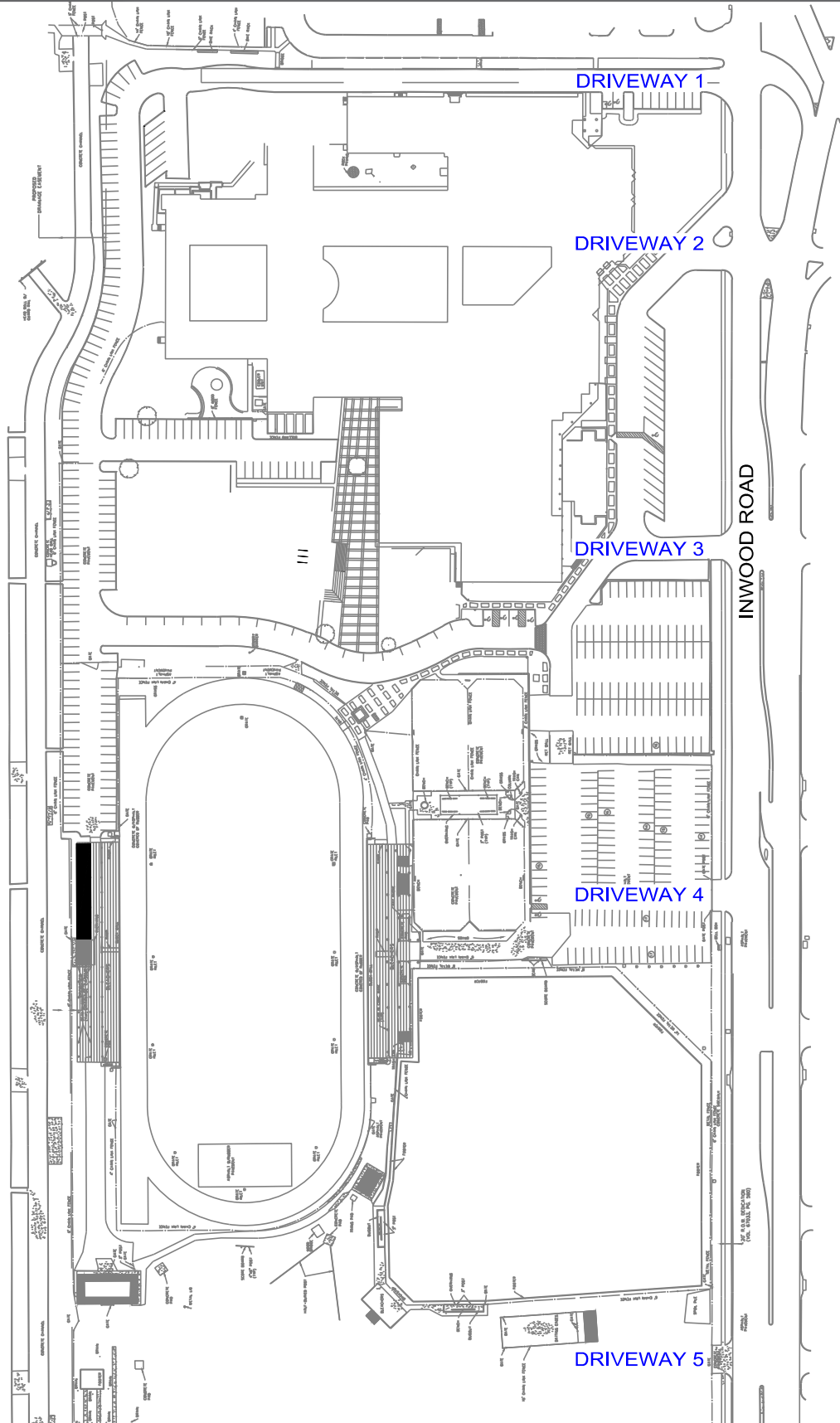

Project Name:

**JESUIT TRAFFIC MANAGEMENT PLAN**

Sheet Title:

**SITE ACCESS**

WPMA P.N.:

M04-17002-00

Designed by:

ECC

Sheet No.

Date:

JUNE 2018

Drawn by:

TME

**FIGURE 1**

The “RIGHT TURN ONLY” sign is permanently placed at Driveway 3 exit to alert motorists of the time sensitive left turn restriction. The EXIT ONLY sign is portable and can be used when and where most appropriate.



Driveway 4 is currently restricted to right-turn out movement and serves students leaving from the parking area as well as an auxiliary departure driveway for vehicles from the student drop-off and pick-up operations. A DO NOT ENTER sign and EXIT ONLY sign are posted at Driveway 4 facing Inwood Road. Driveway 4 is not located at a median opening.

Driveway 5 is typically gated and provides school access for visiting school buses; the internal roadway at Driveway 5 does not circulate to the other vehicular roadways on the Jesuit campus.

#### CIRCULATION

Jesuit staff and administrators and most upper classmen park on-site. Operations for student drop-off and pick-up occur along the front of the school and **Figure 2** illustrates the current TMP for the Jesuit campus.

Parents enter the Jesuit campus from Inwood Road at Driveway 2 with either a left turn or a right turn. The area from Inwood Road all along the front of the school is utilized for students to either unload or load into the vehicles. The pavement width of the area adjacent to the front of the school accommodates three lanes of vehicles so that two queue lines can form and a center lane is available for departing vehicles. Angled parking is located adjacent to this drop-off and pick-up area.

**LEGEND:**

- NO PARKING DURING STUDENT DROP OFF OR PICK UP
- QUEUE LINE DURING STUDENT DROP OFF AND PICK UP
- "ESCAPE" LANE AND DEPARTING CAMPUS PATH
- JESUIT TRAFFIC CONTROL PERSONNEL
- ENTERING CAMPUS MOVEMENTS

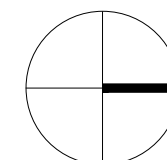

SCALE: 1" = 50'

**NOTE:**

IN QUEUE LINE, CONTINUE TO MOVE FORWARD; DO NOT LEAVE EMPTY QUEUE SPACE IN FRONT OF YOU



**JESUIT TRAFFIC MANAGEMENT PLAN**

**INTERIM REVIEW ONLY**  
Document Incomplete: Not intended for permit or construction.  
Engineer: ELIZABETH C. CROWE, P.E.  
P.E. Serial No.: 70869  
Date: JUNE 1, 2018  
Walter P. Moore and Associates, Inc.  
TBPE Firm Registration No. 1856

NO.	DATE	REVISION

DESIGNED BY	ECC
REVIEWED BY	ECC
DRAWN BY	TME
PROJECT NUMBER	M04-17002-00
DATE	JUNE 2018
SHEET TITLE	

2017-2018 TMP  
SHEET NUMBER

**FIGURE 2**

P:\M04\2017\17002-00 Jesuit Master Plan TrafficParking\CadTraffic\M04-17002-00-TMP-FIGURE-02.dwg

May 31, 2018 - 1:01pm

Generally, the parents line up inside the campus in two lines leaving the middle lane open for vehicles to pass through. Typical operations during the afternoon pick-up are illustrated in Photos 1 and 2.



Photo 1 – Two lines of vehicles queued inside Jesuit Campus



Photo 2 – Vehicle exiting queue through middle lane - April 19, 2018 4:04 PM

The parents generally follow an orderly manner to pick up the students however several previous habits have contributed to less than efficient operations for the vehicle queue line along Inwood Road. Two specific “violations” of best TMP practice were observed on multiple occasions during data collection and are shown in the following photos.

1. Parked vehicles left unattended in the queue lanes adjacent to the school, and
2. Gaps in the queue line inside the campus while vehicles waiting outside the campus to enter from Inwood Road.



Photo 3 – Gap in queue line inside campus



Photos 4 and 5 - Unattended parked vehicles along curb inside Jesuit Campus

The vehicle in Photo 6 was observed parked with no one inside for over 20 minutes in front of the school on April 24<sup>th</sup>. This same vehicle was observed parked along the curb side lane with no driver or passenger again on Monday April 30, 2018.



Photo 6 - Vehicle observed to be parked unattended from 3:50 PM – 4:12 PM

The following photo was taken April 24, 2018 at 3:26 PM at the Jesuit Driveway 2 entry. Four vehicles were queued on southbound Inwood Road, although plenty of queueing space was available inside the Jesuit campus. Personal preference, habits and lack of enforcement of a TMP have contributed to vehicles queued on Inwood Road.



Photo 7 - April 24, 2018 3:26 PM

The afternoon operations for picking up students is typically the time when the longest vehicular queues are observed at school campuses. Observations at the Dallas Jesuit College Preparatory campus confirmed this phenomenon.



The following table provides sample observed vehicular queues on Inwood Road. The peak observed conditions for vehicles outside of the Jesuit Campus are represented during the peak operations of student drop-off and pick-up. Similar to most school campuses, the peak queuing conditions observed at Jesuit lasted for minimal time; typically between one to two minutes.

Vehicular Queue Observations on Inwood Road at Jesuit Driveway 2 Entry					
Date	Day of Week	# Vehicles Waiting to Enter Jesuit			Time
		Northbound Left	Southbound Right	Total Outside Jesuit	
April 10, 2018	Tuesday	0	4*	4	7:50 AM
April 19, 2018	Thursday	1	1	2	3:50 PM
April 20, 2018	Friday	1	0	1	7:41 AM
April 24, 2018	Tuesday	0	4***	4***	3:27 PM
April 30, 2018	Monday	0	1	1	3:45 PM
May 2, 2018	Wednesday	6	5*	11	7:50 AM
May 2, 2018	Wednesday	1	12	13	3:41 PM
Jesuit began implementing TMP strategies					
May 4, 2018	Friday	3	5	8	3:35 PM
May 7, 2018	Monday	2	0	2	7:49 AM
May 7, 2018	Monday	2	4	6	3:42 PM
May 8, 2018	Tuesday	6**	4	10	3:38 PM
May 9, 2018	Wednesday	2**	1	3	3:41 PM

\* Vehicles entering campus southbound were in a rolling queue.

\*\* Left turning vehicles waiting for sufficient gaps in traffic stream to safely enter the campus.

\*\*\* Available space inside Jesuit Campus to accommodate more vehicles inside.

The inside vehicular queuing on the Jesuit campus was also observed. The existing Jesuit campus provides for 17 vehicles to queue along the inside curb line and 14 vehicles to queue adjacent to the angled parking spaces for a total of 31 vehicles in two queue lines.

Figure 3 provides the proposed TMP with the modifications to the Jesuit campus.

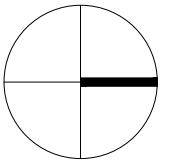

SCALE: 1" = 50'

LEGEND:

- NO PARKING DURING STUDENT DROP OFF OR PICK UP
- QUEUE LINE DURING STUDENT DROP OFF AND PICK UP
- ADDITIONAL VEHICLE QUEUING SPACE ON CAMPUS
- "ESCAPE" LANE AND DEPARTING CAMPUS PATH
- P - JESUIT TRAFFIC CONTROL PERSONNEL
- ↶ - ENTERING CAMPUS MOVEMENTS

NOTE:

IN QUEUE LINE, CONTINUE TO MOVE FORWARD; DO NOT LEAVE EMPTY QUEUE SPACE IN FRONT OF YOU

P:\M04\2017\17002-00 Jesuit Master Plan TrafficParking\CadTrafficM04-17002-00-TMP-FIGURE-03.dwg

May 31, 2018 - 12:16pm

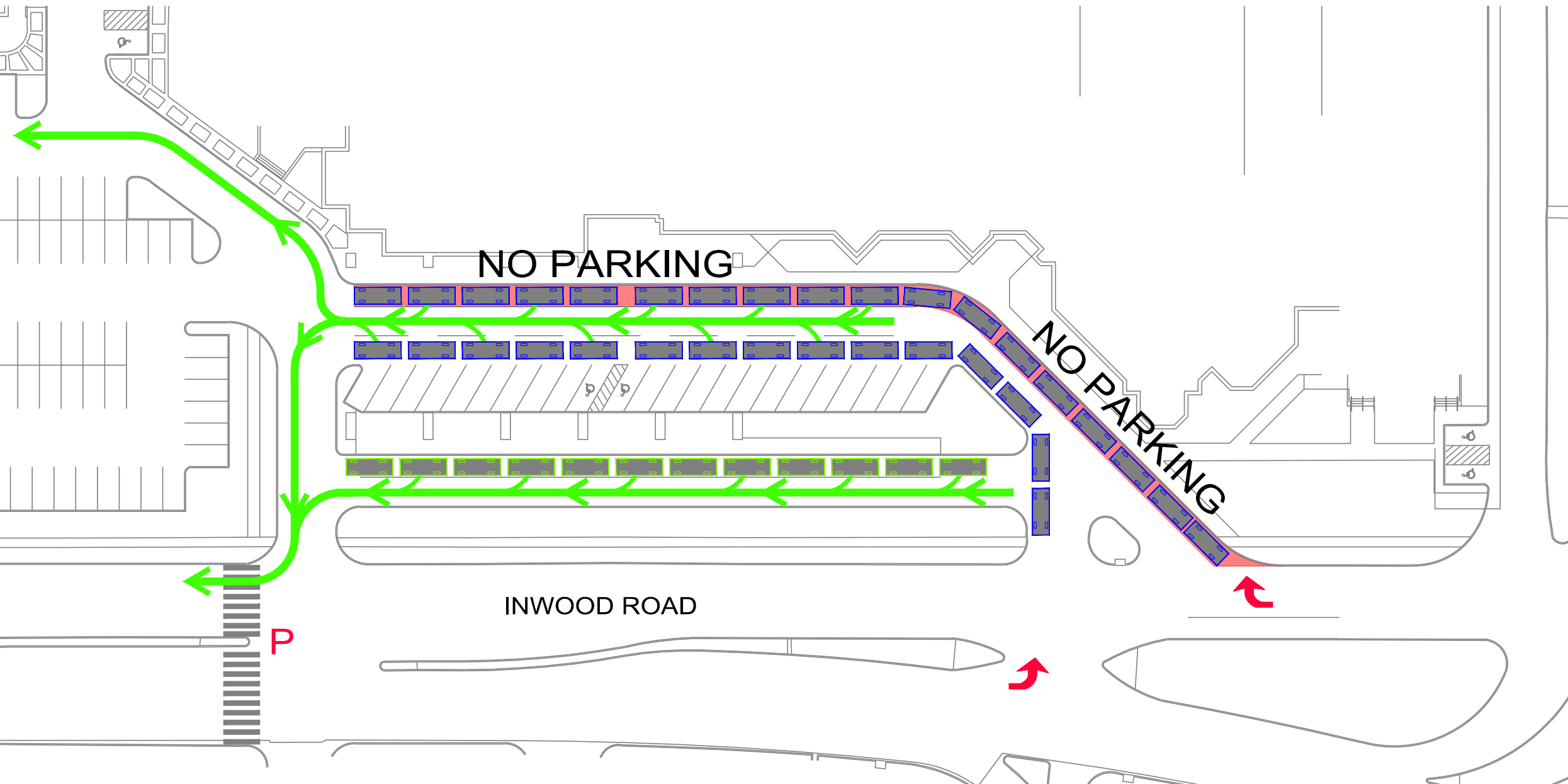

JESUIT  
TRAFFIC  
MANAGEMENT  
PLAN

**INTERIM REVIEW ONLY**  
Document Incomplete: Not intended for permit or construction.  
Engineer: ELIZABETH C. CROWE, P.E.  
P.E. Serial No.: 70869  
Date: JUNE 1, 2018  
Walter P. Moore and Associates, Inc.  
TBPE Firm Registration No. 1856

NO.	DATE	REVISION
DESIGNED BY	ECC	
REVIEWED BY	ECC	
DRAWN BY	TME	
PROJECT NUMBER	M04-17002-00	
DATE	JUNE 2018	
SHEET TITLE		

PROPOSED TMP.

SHEET NUMBER

FIGURE 3

The proposed Jesuit campus plan includes creation of an additional queuing area to accommodate a minimum of 11 vehicles to queue on campus. The proposed TMP is intended to operate very similarly to the current TMP.

The queue of five vehicles along southbound Inwood Road was the longest queue observed during May 2018 after Jesuit began implementing TMP strategies. The proposed plan to provide an additional inside campus queue space to accommodate eleven vehicles would serve to eliminate off-campus queuing on Inwood Road.

## SUMMARY AND RECOMMENDATIONS

Walter P Moore performed observations in April 2018 and May 2018 to review the existing carline operations. **Figure 2** illustrates the current TMP and **Figure 3** provides the TMP with the additional queuing space on the proposed site plan. The proposed additional space parallel to Inwood Road provides for an estimated eleven additional vehicles to queue on site which would accommodate the peak overflow of queued vehicles during peak times of student pick-up operations.

The following recommendations are provided to increase the efficiency of the carline procedures and reduce the likelihood of vehicles queued on Inwood Road waiting to enter the Jesuit Campus.

- Educate the carline staff members, police assistance, parents and students of the elements in the TMP to achieve more efficient expediting processes for the drop-off and pick-up operations.
- Enforce the “No Parking during Student Drop-off and Pick-up” along the front of the school.
- Have parents continue to move up in the queue line of vehicles in front of them. Do not leave gaps in the line; move forward. Jesuit staff may need to initially provide assistance to “train” the parents on the procedures.
- Maintain an off-duty uniformed officer on campus to assist with directing school traffic when necessary.
- Monitor operations at Driveway #3 during the morning and afternoon peak operations. To reduce conflict movements, restrict the northbound left turn ingress

movement from Inwood Road with temporary traffic cones as is currently practiced during the afternoon.

The school administration at Jesuit College Preparatory School of Dallas is acutely aware of the proposed Transportation Management Plan; members have reviewed and approved the TMP.

Several of the recommendations to improve the existing operations were implemented in May 2018 with significantly improved queuing results.

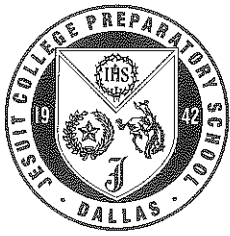

### REVIEW AND COMMITMENT

The school traffic management plan for Jesuit College Preparatory School of Dallas was developed with the intent of optimizing safety and accommodating vehicular traffic queues generated during school peak hours. A concerted effort and full participation by the school are essential to maintain safe and efficient traffic operations.

Jesuit has reviewed and approved this traffic management plan, and will implement the recommendations found under the "Summary and Recommendations" section of the attached school traffic management plan.

Signature

A handwritten signature in black ink, appearing to read "Michael A. Earsing".

8/14/18

Name: Michael A. Earsing

Title: President, Jesuit College Preparatory School of Dallas